

F-120 ASTM E-119 Wire Reinforcement Specification

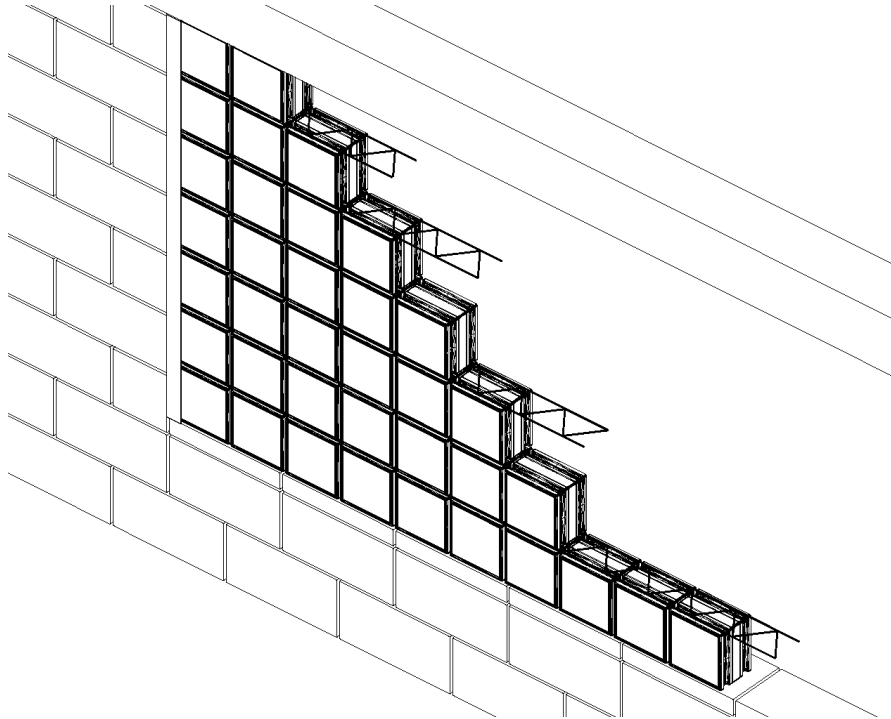

DRAWINGS FOR ILLUSTRATIVE PURPOSES ONLY

Truss-Type: are continuous lengths of joint reinforcement that are embedded into the horizontal mortar joints of the masonry walls.

MATERIAL CONFORMANCE

Joint reinforcement products conform to:

ASTM A951/A951M (Standard Specification for Steel Wire for Masonry Joint Reinforcement)

ACI / ASCE 530 (Building Code Requirements for Masonry Structures)

Wire (Carbon Steel):

Prefabricated from cold-drawn steel wire conforming to

ASTM A1064/A1064M

Tensile Strength - 80,000 p.s.i. | Yield Point - 70,000 p.s.i. minimum

Mill Galvanized coating:

ASTM A641/A641M (0.1 oz/ft²)

Available special order:

ASTM A641/A641M (0.4oz/ft²)

ASTM A641/A641M (0.8 oz/ft²)

Hot-Dip Galvanized after fabrication:

ASTM A153/A153M-B2 (1.5 oz/ft² minimum)

Wire (Stainless Steel): **ASTM A580/ASTM A580M** - AISI Type 304 (Type 316 available on special order)

Wire Diameter:

9 gauge (.148" or W1.7) or 3/16" \varnothing (.187" or W2.8)

Side Rods and Cross Rods available in any combination of the above. Cross Rods welded 16" O.C.

Finishes:

Hot-Dip Galvanized

Stainless Steel - Type 304

Note: Seves Glass Block recommends Stainless Steel for maximum protection against corrosion.

Wire Size (10' length standard, custom length available special order):

(S) Standard Weight:

9 Gauge Side Rods x 9 Gauge Cross Rods

Block Size:

6"